

Parts List

Parts List

No.	Name	Qty
1	Electric Leg (Left)	1
2	Electric Leg (Right)	1
3	Beam	1
4	Bracket	2
5	Connecting Beam	1set
6	Cable Tray	1
7	Feet	2
8	Adapter	1
9	Handset	1
10	Desk Screen Clamp	2set
11	Plastic Cover	2
12	Adapter Holder	1
13	Connecting Beam Connector	2

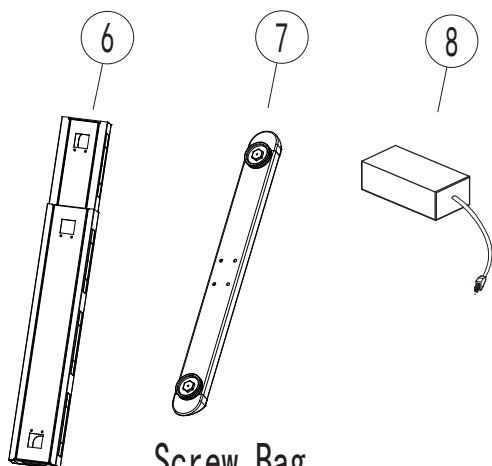
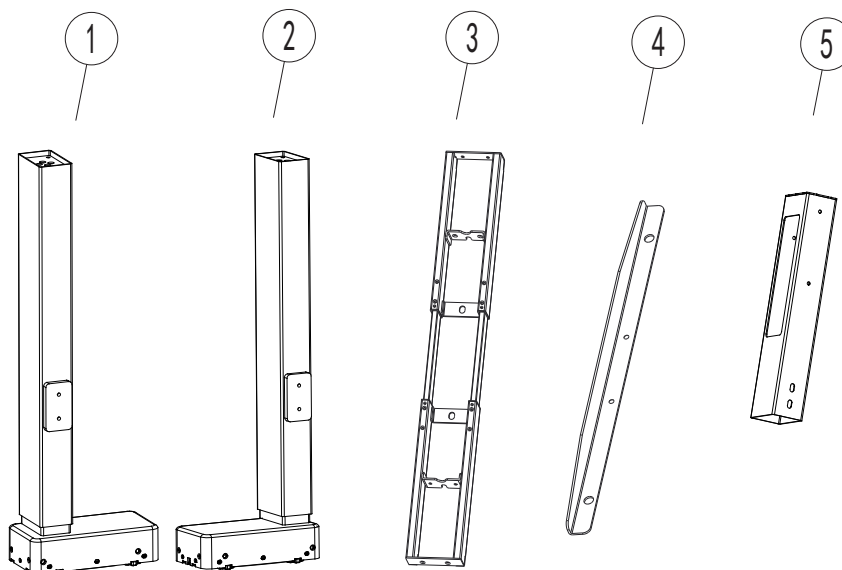

Screw Bag

No.	Name	Qty
1	M6*10 Screw	14
2	M6*12 Screw	12
3	M6*40 Screw	8
4	M6*16 Screw	8
5	M6*8 Screw	10
6	Rubber Cushion	6
7	Plastic Plug	6
8	ST3.5*19 Screw	2
9	ST4.8*25 Screw	6
10	4mm Hex Spanner	1
11	5mm Hex Spanner	1

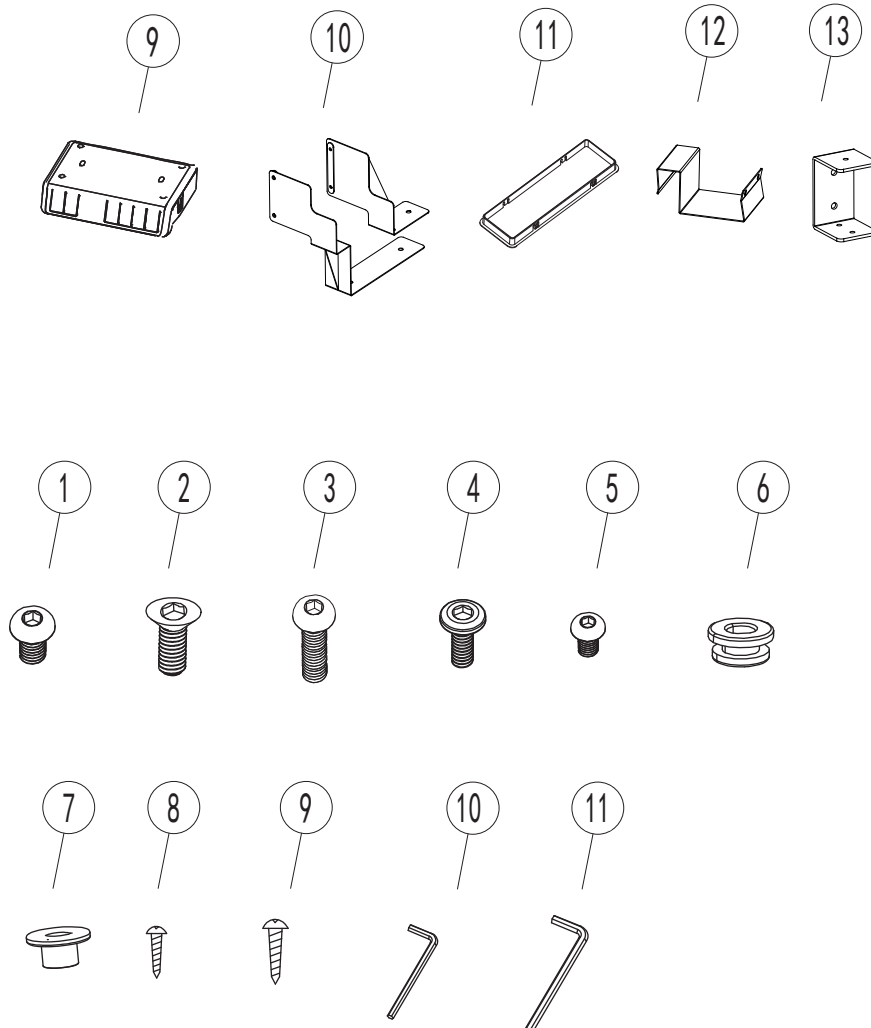

Assembly Instructions

- 1 Loosen the M6*10 screws on the main beam with 4mm hex spanner.

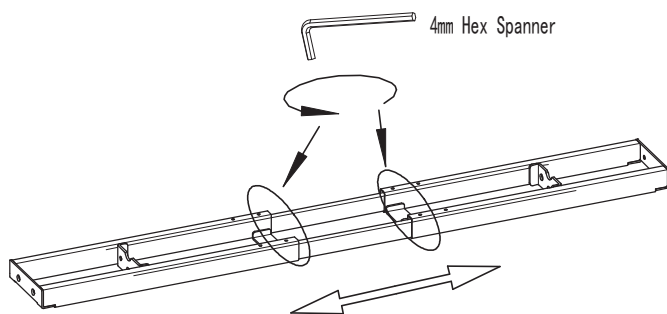

- 2 Attach the connecting beam connectors to the legs using 4 of M6*10 screws, and attach the electric legs to the main beam using 8 of M6*12 screws.

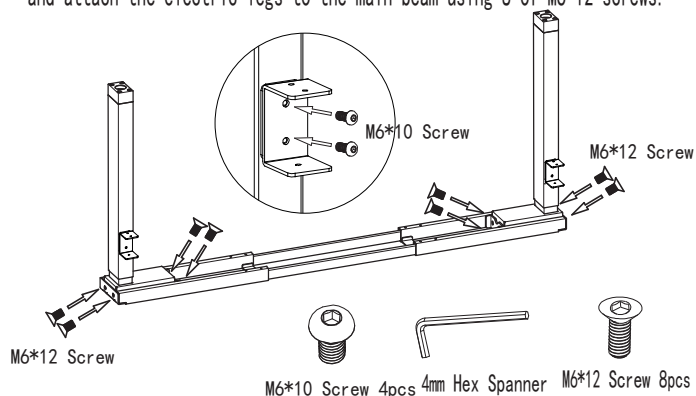

- 3 Attach the feet to the electric legs using 8 of M6*40 screws.

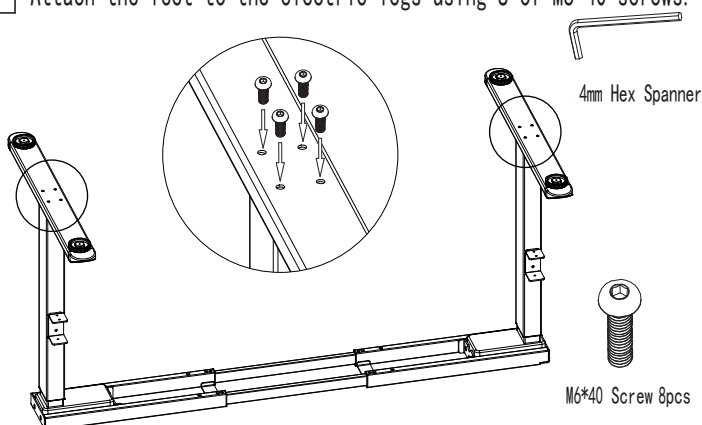

- 4 Attach the connecting beams to the electric legs using 6 of M6*10 screws.

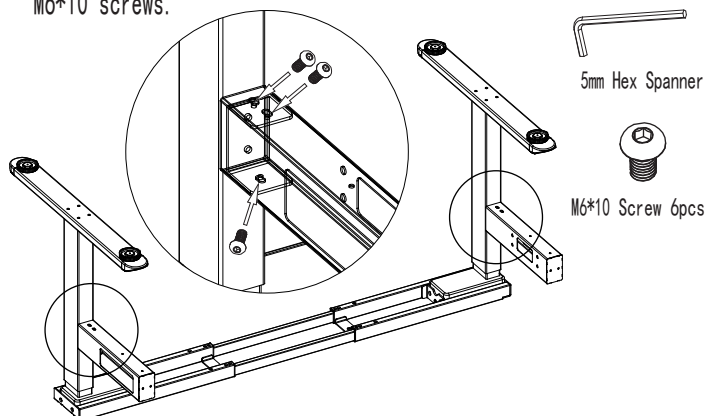

- 5 Attach the cable tray to the connecting beams using 8 of M6*16 screws, then install the plastic covers to the connecting beams.

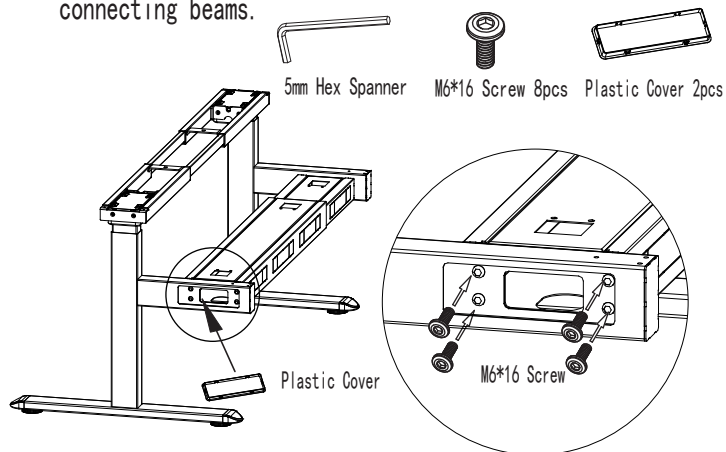

- 6 Attach the brackets to the beams using 4 of M6*12 screws, then fit the rubber cushions and plastic plugs to the beam and brackets.

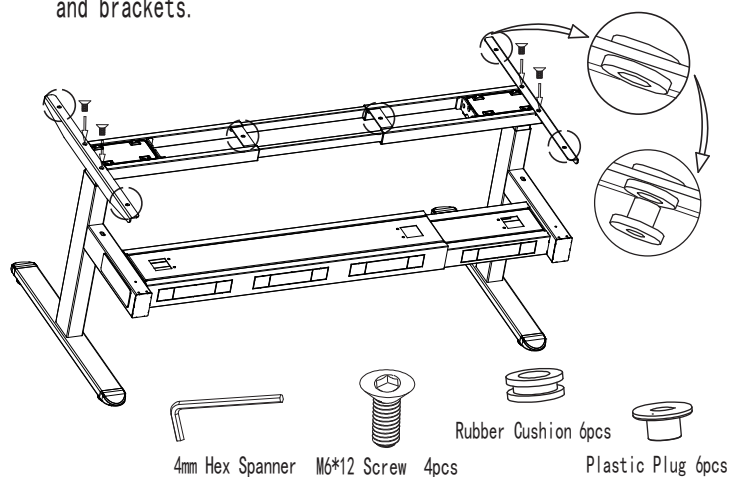

- 7 Attach the screen clamps to the connecting beam using 10 of M6*8 screws.

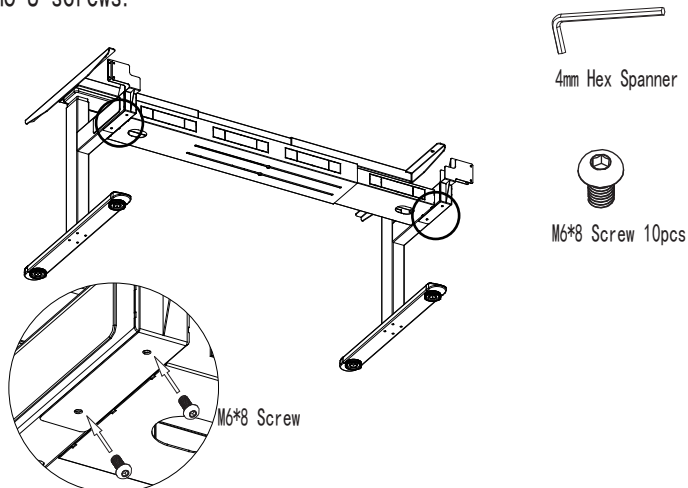
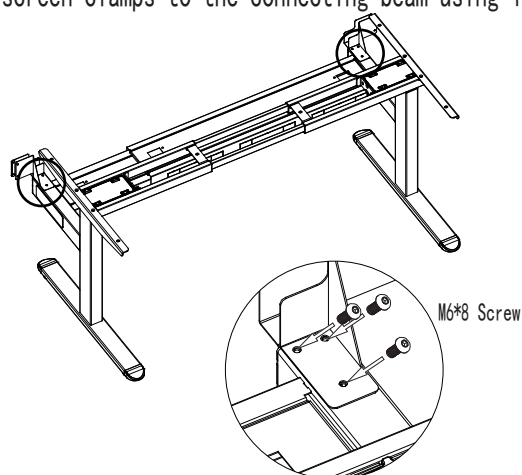

Assembly Instructions

- 8 Fix the adapter into the adapter holder, then attach the holder to the beam.

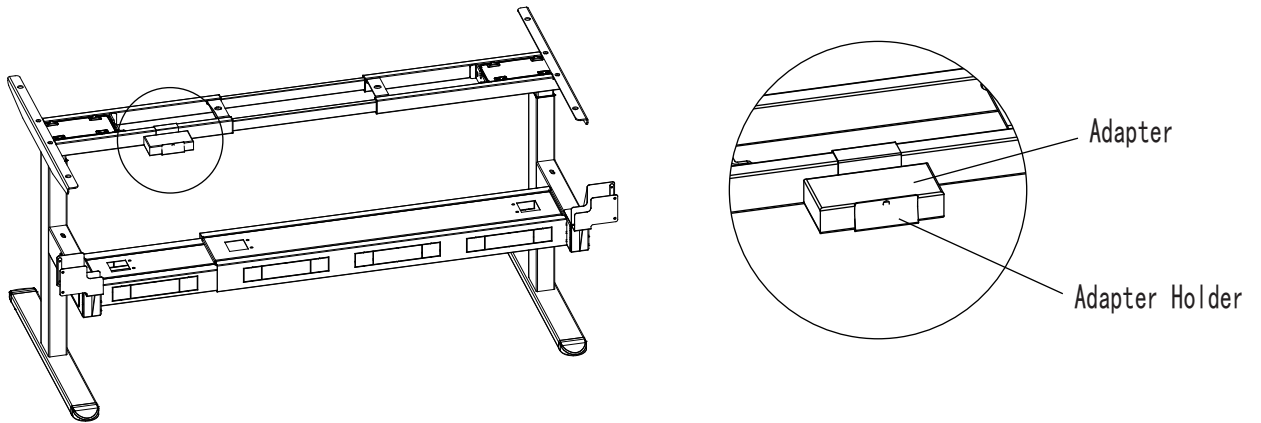

- 9 Attach the desk frame to below desktop using 6 of ST4.8*25 screws, then attach the handset to below desktop using 2 of ST3.5*19 screws. (Secure the beam using M6*10 screws from the screw pack along with the screws on the beam.)

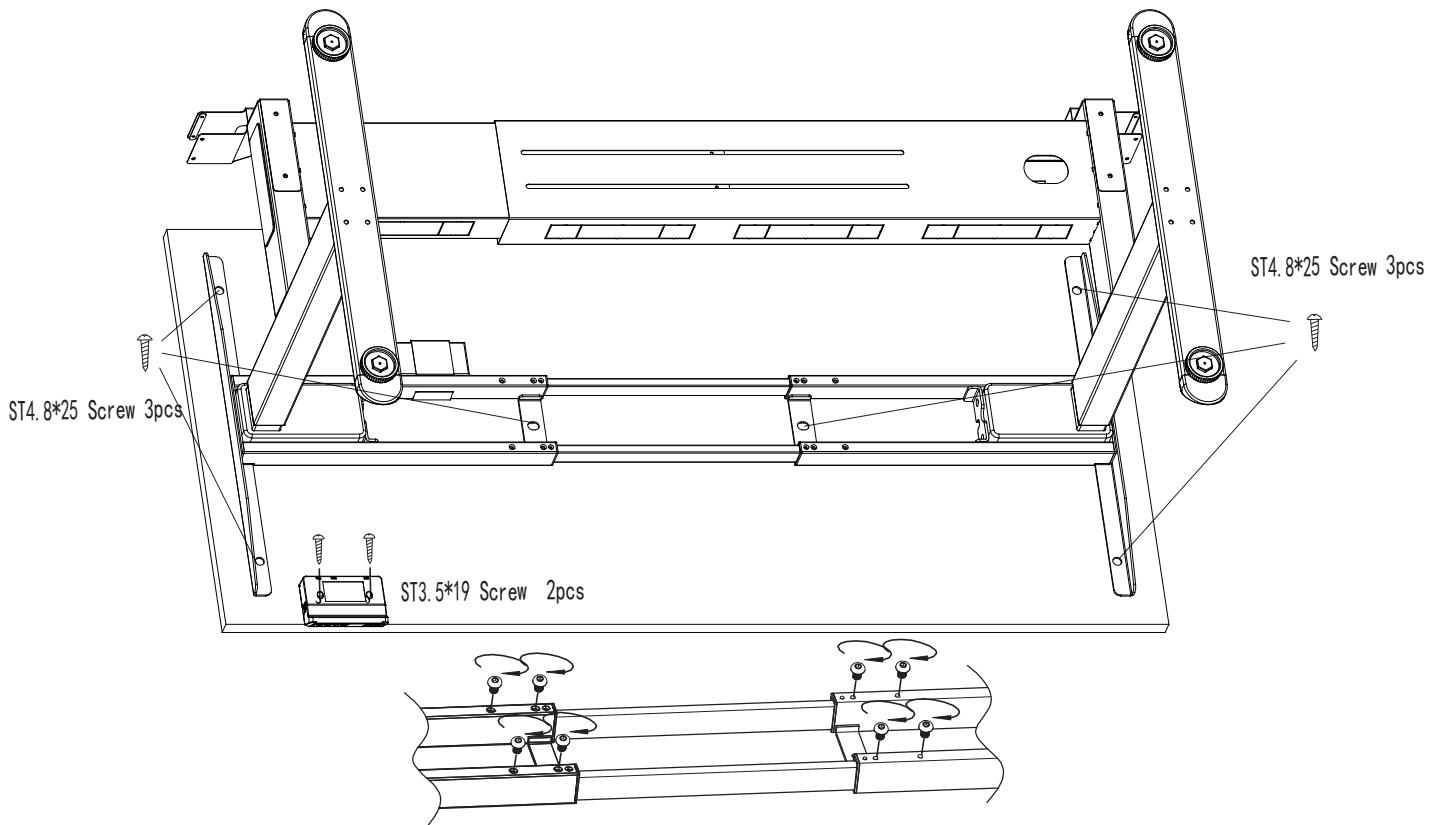

- 10 Connect the electric leg cables and adapter cable to the handset, then plug the power cord into the adapter.

