

VOYAGE BK

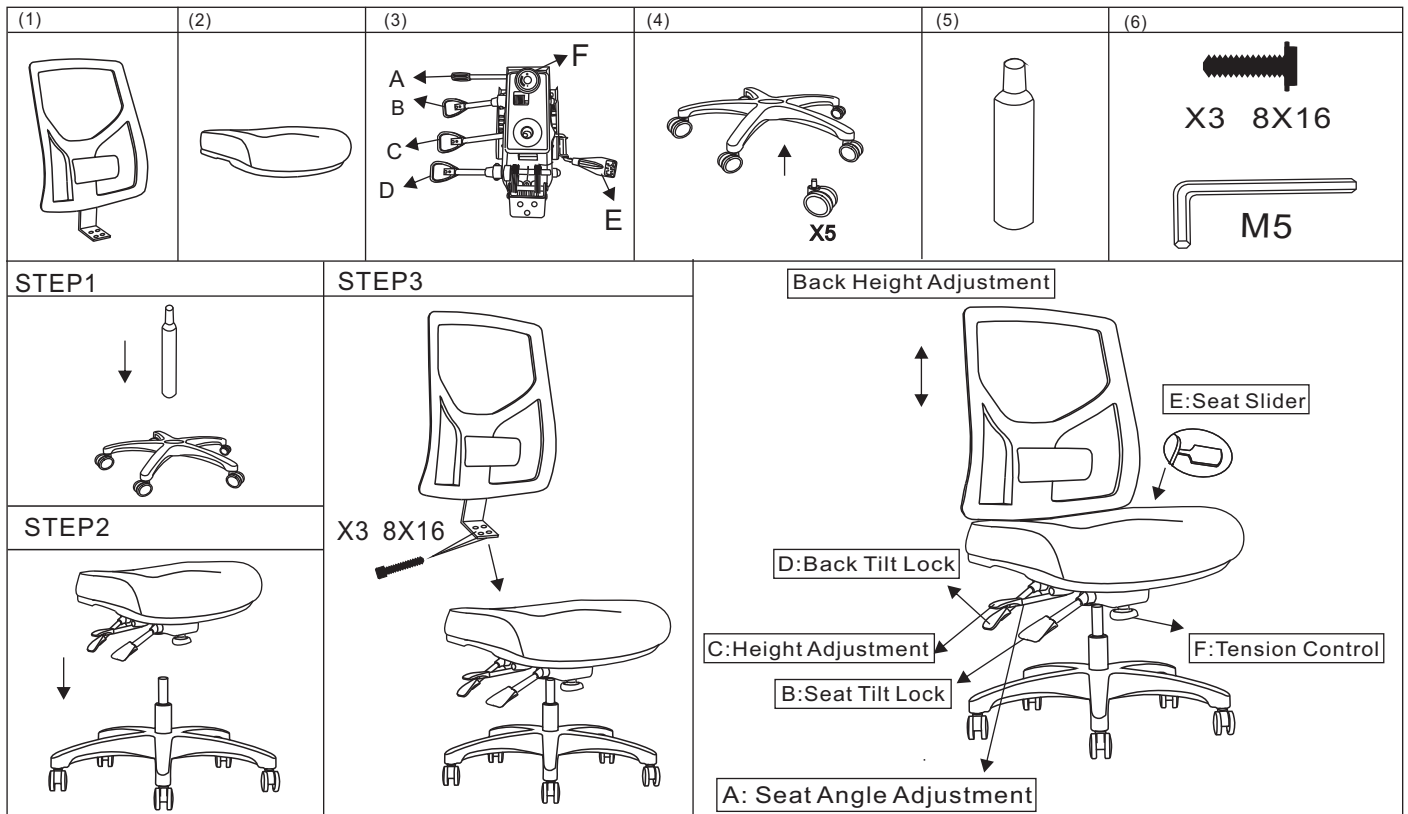

User Information

- *Lever A: Seat initialized angle adjustment.
Unlock the Lever B, then turn Lever A to lock desired angle.
- *Lever B: Seat tilt. Press the lever down to lock seat position.
- *Lever C: Seat height adjustment. Lift the lever to adjust the seat lower or higher.
- *Lever D: Back tilt. Press the lever down to lock back position.
- *Lever E: Seat depth adjustment. Lift the lever and slide the seat forward or backward.
- *Lever F: Tilt tension adjustment.
Turn the knob clockwise/counterclockwise to the right tension for your weight.
- *Lumbar support: Up/down for height adjustment. Turn the knob for forward/backward.

CHAIR CARE

- *Clean regularly
- *Use wet towel where is applicable
- *Test on concealed area before proceeding

WARNING

- *Do not use this chair unless all bolts/knob are tightened and this chair is assembled firmly and properly.
- *This chair is for one person to sit on. Do not stand on the chair.
- *Do not touch mechanism except lever handle/knob when people is sitting in.
- *Only trained personnel replace or repair cylinder.
- *Failure to follow these warnings could result in serious injury.